



Whale®

Easi-Slide Exterior Utilities.Sockets

A wide range of recreational vehicle exterior utilities sockets featuring unique Whale Easi-Slide Lid.

8
different
sockets
available



Electrical, gas and water utilities sockets available

Whale's unique Easi-slide lid with streamlined design –

- No more lid flapping noise or damage
- Smooth easy slide open & close motion
- Secure click close feature protects internal parts when not in use

Ease of installation – can be either bonded or screwed into place

- Designed for bonding - Flat back with textured finish
- Clean finish - 'Snap through' screw holes prevent bonding agent from spilling through



- Sleek design - uniform look on the vehicle's exterior walls
- Comfortable to use
- Waterproof protection
- High quality satin finish UV stabilised to prevent damage from sunlight

**Lids available in 2
colour options - crisp
white and soft grey**



PROUD TO MANUFACTURE IN THE UK

1. Water In Socket

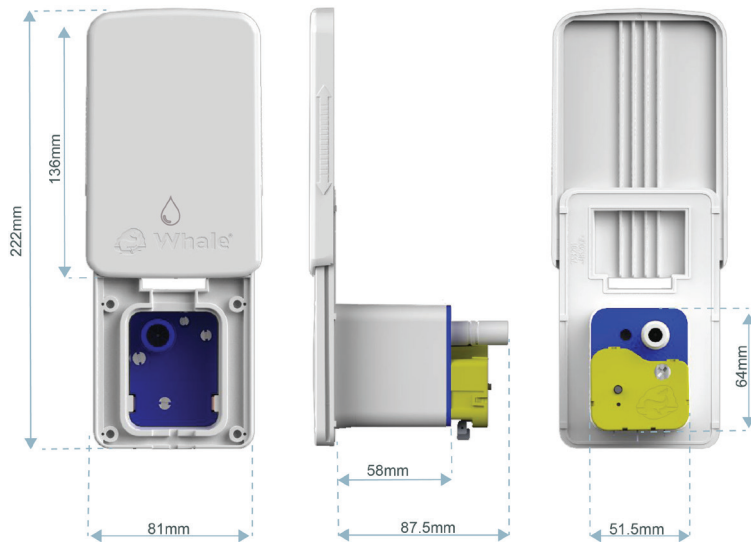

The easy way to supply your vehicle with fresh water. Includes sockets for exterior submersible pumps, mains water hook up or on board water pump. Use with cold freshwater only.

Ideal for use with

Whale Watermaster® exterior water pump with Easi-Push Plug
Product Code - EP1612 (Retail)

Whale Watermaster® Mains
Product Code - EM9433 (Retail)



Technical info:

Water In Socket Product Codes	Watermaster IC Socket – ES8005BR	
Easi-Slide Lid Product Codes	AK1411B (Bulk Packaging) – Crisp White AK1412B (Bulk Packaging) – Soft Grey	AK1411 (Retail) - Crisp White AK1412 (Retail) - Soft Grey
Voltage	12V d.c.	
Weight	0.19kg	
Plumbing Connections	12mm male stem Whale Quick Connect	
Materials in Contact With Water	ABS, PP, EPDM, Nitrile, NBR, stainless steel	
Compliance	IP45 rated when lid closed	

2. Water Out Socket



For hassle-free wash down, easily connect Whale's detachable exterior Compact Shower with easy-to-use trigger. Use with cold freshwater only.

Ideal for use with

Whale Compact Shower with 2.6m hose
Product Codes - SO4100B (Bulk Packaging), SO4100C (Retail)



Technical info:

Water Out Socket Product Codes	SO4000C (Retail) SO4000B (Bulk Packaging)	
Easi-Slide Lid Product Codes	AK1428B (Bulk Packaging) – Crisp White AK1448B (Bulk Packaging) – Soft Grey	AK1427C (Retail) - Crisp White AK1447C (Retail) - Soft Grey
Weight	0.58kg	
Plumbing Connections	12mm female	
Materials in Contact With Water	PP, ABS, Hostaform, stainless steel, NBR, reinforced PVC	
Compliance	IP55 rated when lid closed	

3. Motorhome Filler Socket

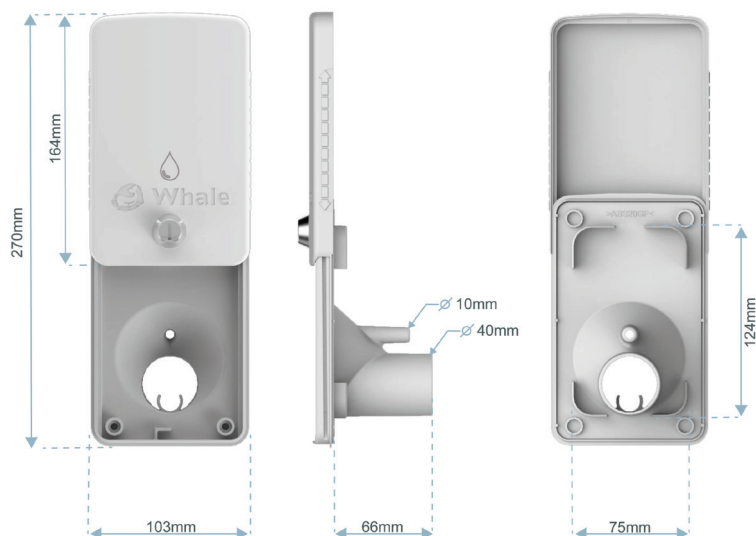

Directly fill your on-board water tank with the Motorhome Filler Socket. The unique secure hose clip keeps the pump in place during filling. The tank fill design incorporates a lock to protect your water supply and a vent pipe to prevent airlocks. The Motorhome Filler Socket is suitable for use with any standard hose and should be used with cold freshwater only.

Ideal for use with

Whale Portable Pump Kit
Product Code -
GP1642 (Retail)



Technical info:

Motorhome Filler Socket Product Codes	SO2000C (Retail) SO2000B (Bulk Packaging)	
Easi-Slide Lid Product Codes	AK1432B (Bulk Packaging) – Crisp White AK1452B (Bulk Packaging) – Soft Grey	AK1432C (Retail) - Crisp White AK1452C (Retail) - Soft Grey
Weight	0.15kg	
Plumbing Connections	40mm DIA pipe, 10mm DIA bleed pipe	
Materials in Contact With Water	ABS	
Compliance	IP55 rated when lid closed	

4. Motorhome Filler + 12V Socket

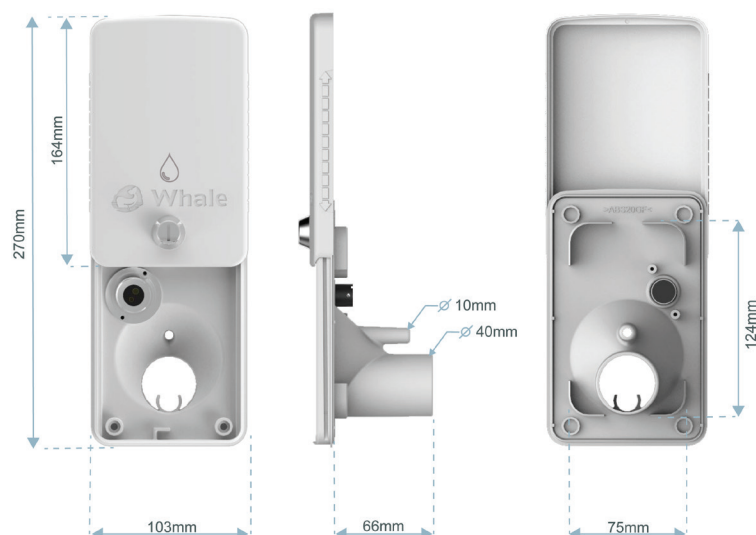

Unique 2 in 1 design includes a 12V pump power supply and Motorhome fill all in one socket. The secure hose clip keeps the pump in place during filling. The Motorhome Filler + 12v Power Socket incorporates a lock to protect your water supply and a vent pipe ensuring the tank is vented at all times, preventing airlocks. This socket is suitable for use with any standard hose and is to be used with cold freshwater only.

Ideal for use with

Superfil Pump Kit
Product Code -
GP1333B (Bulk Packaging),
GP1333 (Retail)



Technical info:

Motorhome Filler + 12v Power Socket Product Codes	SO2500C (Retail) SO2500B (Bulk Packaging)	
Easi-Slide Lid Product Codes	AK1432B (Bulk Packaging) – Crisp White AK1452B (Bulk Packaging) – Soft Grey	AK1432C (Retail) - Crisp White AK1452C (Retail) - Soft Grey
Voltage	12V d.c.	
Weight	0.18kg	
Plumbing Connections	40mm DIA pipe, 10mm DIA bleed pipe	
Materials in Contact With Water	ABS	
Compliance	IP55 rated when lid closed	

**Unique
2 in 1
design**

5. Mains Electric Out Socket

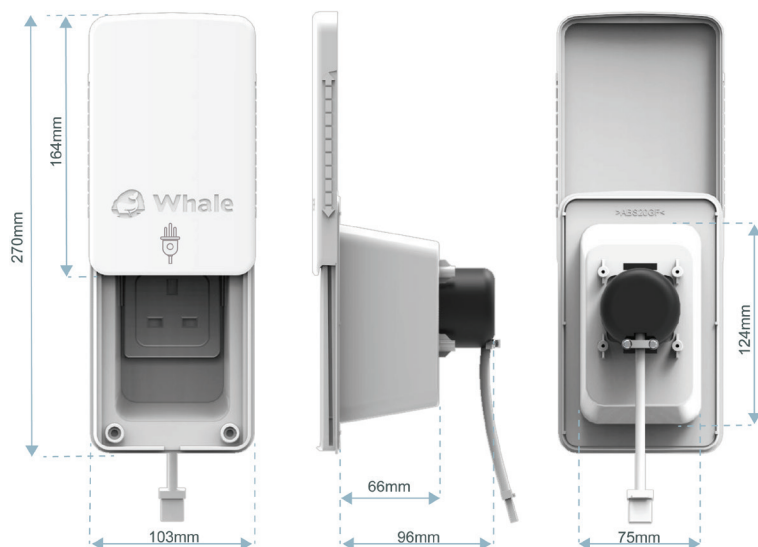

This easy access mains outlet socket includes a UK 3 pin which allows you to hook up electrical appliances to 13-amp rating such as power tools, lighting, TVs, or games consoles. Easi-Slide lid can be closed completely when in use, weather-proofing the unit against the elements.



Technical info:

Mains Electric Out Socket Product Codes	SO3000C (Retail) SO3000B (Bulk Packaging)
Easi-Slide Lid Product Codes	AK1429B (Bulk Packaging) – Crisp White AK1449B (Bulk Packaging) – Soft Grey AK1427C (Retail) – Crisp White AK1447C (Retail) – Soft Grey
Electrical spec	230V AC / 13Amp
Weight	0.25kg
Electrical Connections	JST plug (LP-03-1)
Compliance	Product complies with BS1363 and IP55 rated when lid closed

6. Multimedia 3 in 1 Socket



Entertainment on the go with the Whale Multimedia Socket. Supplies TV aerial and Satellite as well as providing a 12v d.c. outlet socket to power or charge your devices.



Technical info:

3-in-1 Multimedia Socket Product Codes	SO3500C (Retail) SO3500B (Bulk Packaging)
Easi-Slide Lid Product Codes	AK1430B (Bulk Packaging) – Crisp White AK1450B (Bulk Packaging) – Soft Grey AK1427C (Retail) – Crisp White AK1447C (Retail) – Soft Grey
Voltage	12V d.c., 10Amp
Weight	0.22kg
Electrical Connections	12V – spade connectors SAT & TV – threaded coaxial connections
Compliance	IP55 rated when lid closed

7. Isolator Switch Socket

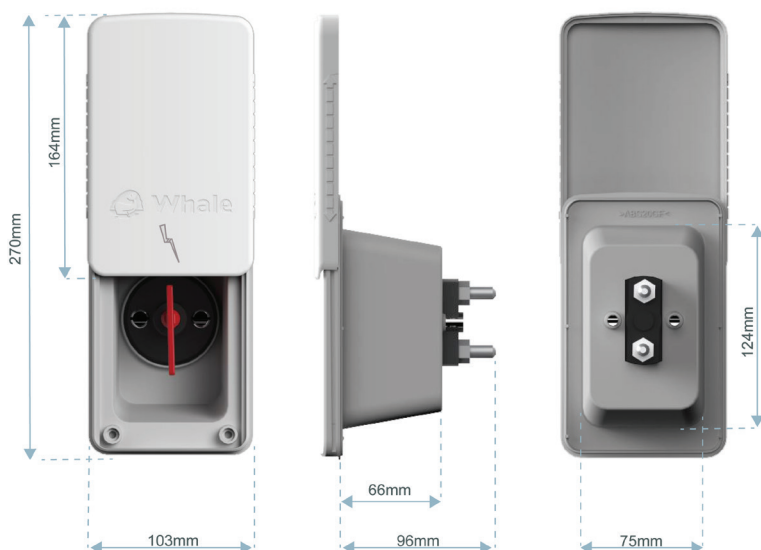

The Whale Isolator Switch allows you to cut the power to your appliances saving valuable battery life.



Technical info:

Isolator Switch Socket Product Codes	SO3200C (Retail) SO3200B (Bulk Packaging)	
Easi-Slide Lid Product Codes	AK1431B (Bulk Packaging) – Crisp White AK1451B (Bulk Packaging) – Soft Grey	AK1427C (Retail) - Crisp White AK1447C (Retail) - Soft Grey
Voltage	12 V d.c. to max 24 V d.c.	
Max Continuous Operating Current	500A 5 Sec Max	
Weight	0.28kg	
Electrical Connections	M8 threaded connections	
Compliance	IP55 rated when lid closed	

8. External BBQ Outlet Socket

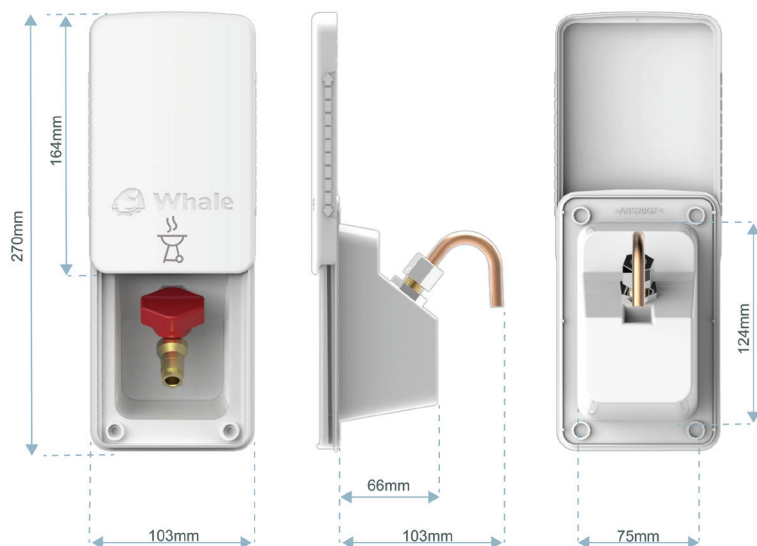

The gas BBQ outlet is ideal for supplying barbecues using your LPG (propane and butane) on board gas supply. With simple one-handed operation and straight forward connection, external gas appliances can be quickly connected to the gas tap. Safety coupling is included to ensure that gas can only be turned on when safety coupling is connected.



Technical info:

BBQ Socket Product Codes	SO1000C (Retail) SO1000B (Bulk Packaging)	
Easi-Slide Lid Product Codes	AK1427B (Bulk Packaging) – Crisp White AK1447B (Bulk Packaging) – Soft Grey	AK1427C (Retail) - Crisp White AK1447C (Retail) - Soft Grey
Working Pressures	4 bar max, 30mBar nominal working pressure	
Weight	0.39kg	
Supply System	LPG	
Gas Connections	M14 x 1.5 threaded nut and compression olive for use with 8mm DIA gas pipe.	
Compliance	Product complies with BS EN 1949 and IP55 rated when lid closed	

Easi-Slide Lids

Supplied separately to the socket, Easi-Slide lids are available in 2 colour options; Crisp White and Soft Grey. Easy fit replacement lids are available to replace lost or broken covers without removing the entire socket or compromising the seal.



Meet the Designer

Andrew Peoples

In 2013, Andrew designed the popular Whale Easi-Slide Lid. Following on from the success of this product, he identified a gap in the market for a suite of sockets with an Easi-Slide lid that were suitable for all types of recreational vehicles including caravans, motorhomes and panel vans. From a gas BBQ point to an easy-to-use multimedia socket, Andrew has created this practical and aesthetically pleasing range of sliding sockets. One unique design to meet all your RV needs, bringing sleek uniformity to your vehicle's exterior.

This Whale product is covered by a 2 year warranty. For details please see our Statement of Limited Warranty.

© Copyright Whale® 2017 – All rights reserved.

Reproduction in whole or in part without permission is prohibited. WHALE® is a registered trademark of Munster Simms Engineering Limited, Bangor, Northern Ireland trading as Whale. Whale's policy is one of continuous improvement and we reserve the right to change specifications without prior notice. Illustrations are for guidance purposes only. Neither the accuracy nor completeness of the information contained in this or any Product literature is guaranteed by the Company and may be subject to change at its sole discretion. Please note that by contacting Whale Support you will be indicating your consent to receiving product updates, recall information, help guides and appropriate marketing messages from us via post, email or telephone unless you indicated an objection to receiving such messages.



PLEASE NOTE: Whale BBQ sockets including the gas hose connector must be installed and serviced by a **Qualified Gas Engineer** in accordance with the Whale installation instructions and BS EN 1949-2011. All electrical work must be carried out by a **competent person** as defined by BS7671 PART 2.



Munster Simms Engineering Ltd.
2 Enterprise Road, Bangor, N. Ireland BT19 7TA
Tel: +44 (0)28 9127 0531
+44 (0)845 217 2933

info@whalepumps.com
whalepumps.com

